

PIANTA PIANO PRIMO
(SOTTOSTRADA)

H=2.10m.

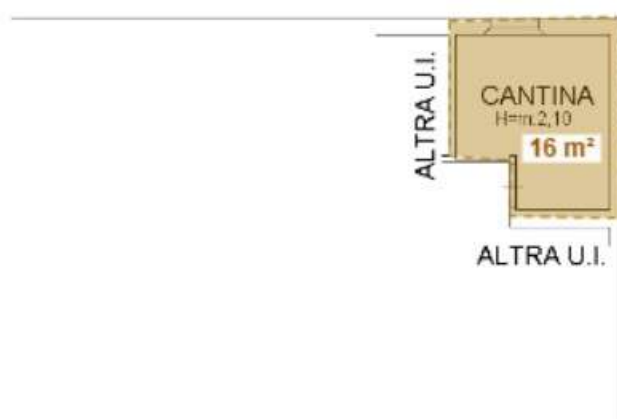

PIANTA PIANO TERRA
(RIALZATO)

H=2.96m.



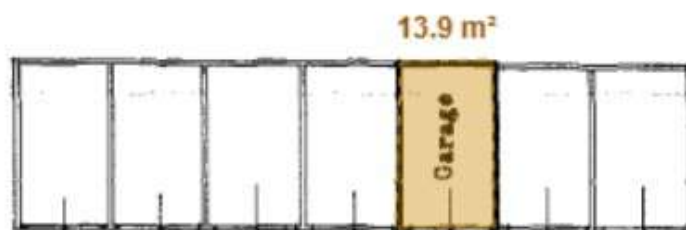

PIANO TERRA
Hm= n.l. 2,35

PLANIMETRIA 1:1000

Foglio 26
Mappale 55

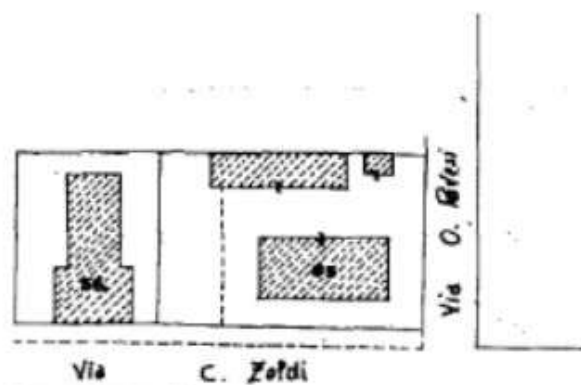

ORIENTAMENTO



SCALA DI 1. 200